

STRUCTURAL BAY SECTION DETAIL

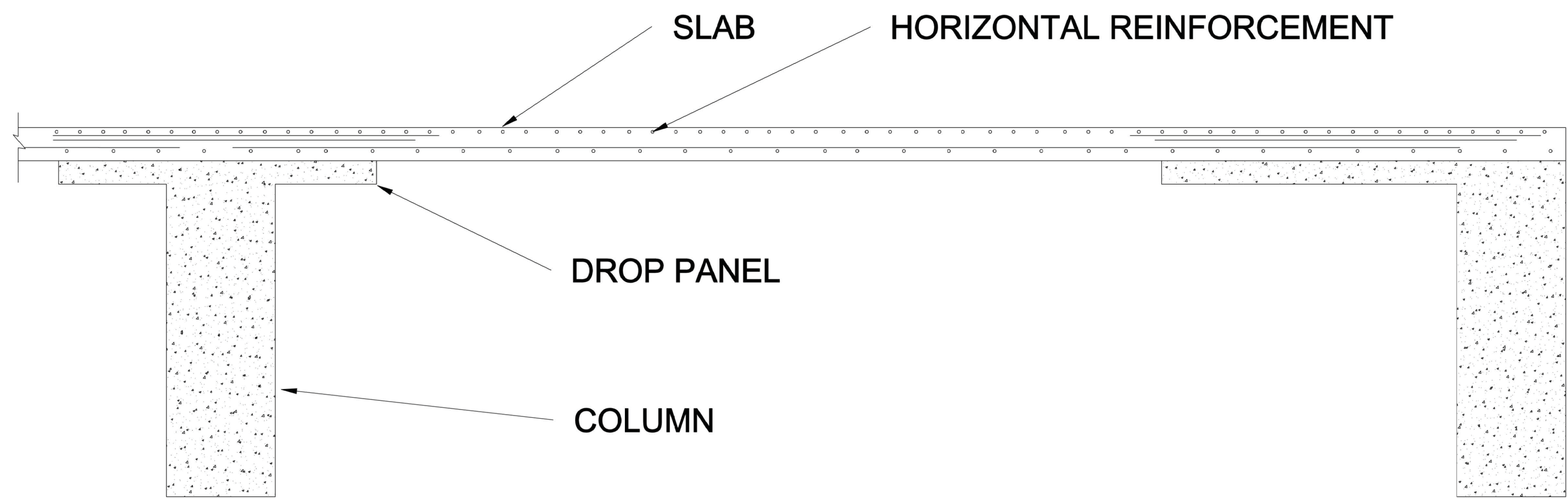

CALCULATIONS TABLE FOR SLAB DEPTH AND DROP PANEL

SPAN = 41.5'

SLAB DEPTH =  $41.5 / 36 = 1' \frac{1}{8}"$

DROP PANEL PROJECTION:  $0.25 * \text{SLAB DEPTH}$

PANEL:  $0.25 * 1.15' = 3.45"$

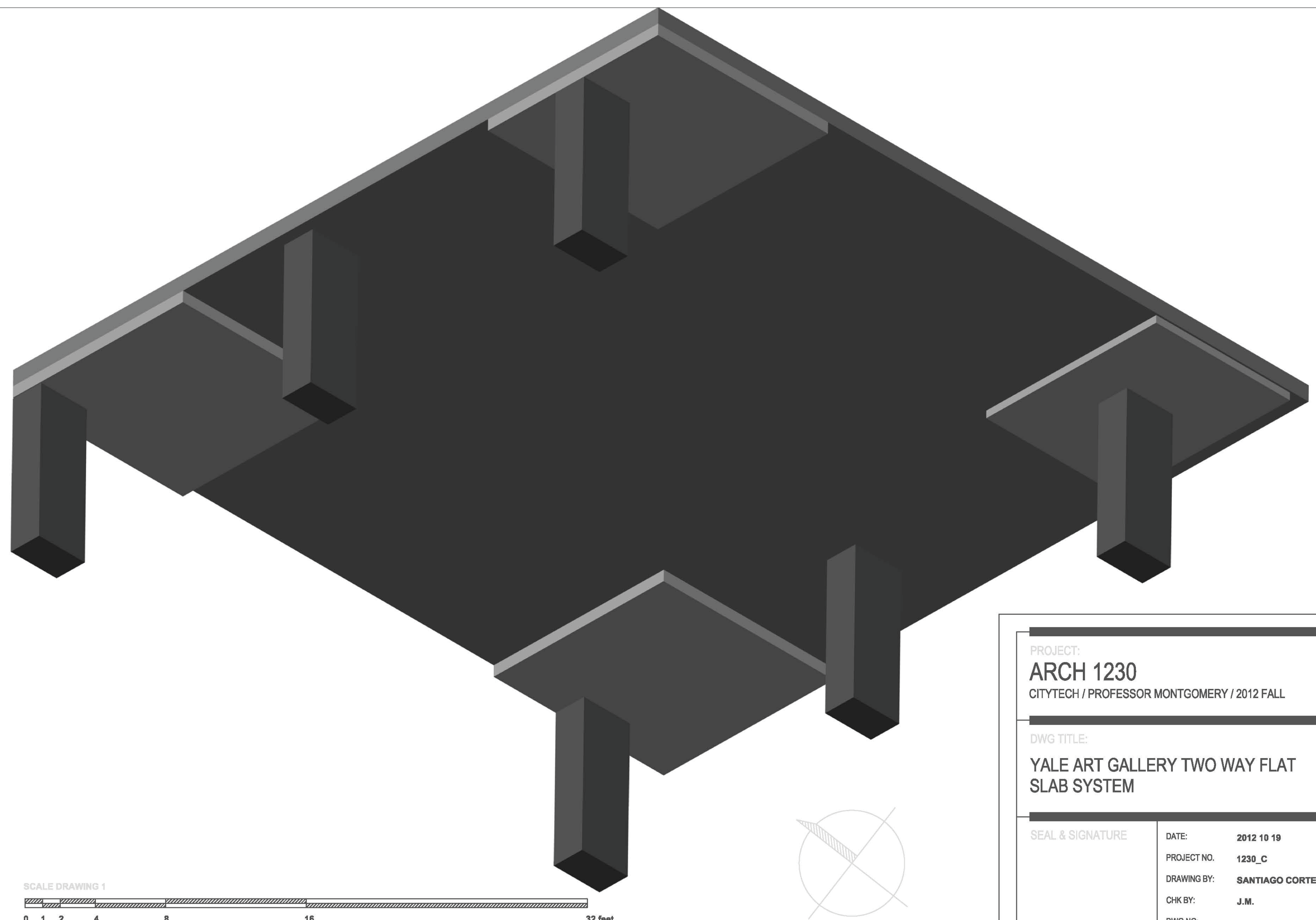

1  
C100.00

Y.A.G.  
DRAWING SCALE (1/8"=1'-0")

|   |                             |
|---|-----------------------------|
| PROJECT:<br><b>ARCH 1230</b><br>CITYTECH / PROFESSOR MONTGOMERY / 2012 FALL |                             |
| DWG TITLE:<br><b>YALE ART GALLERY TWO WAY FLAT SLAB SYSTEM</b>              |                             |
| SEAL & SIGNATURE  | DATE: 2012 10 19            |
|   | PROJECT NO: 1230_C          |
|   | DRAWING BY: SANTIAGO CORTES |
|   | CHK BY: J.M.                |
|   | DWG NO: C-100.00            |
| arch1230_montgomery_2012_cortas_santiago_assign C_01                        | CADD FILE NO: PAGE: 1 of 2  |